



СОЮЗ

ИННОВАЦИИ РОССИИ

ГКС-3515



СОЮЗ

ИННОВАЦИИ РОССИИ

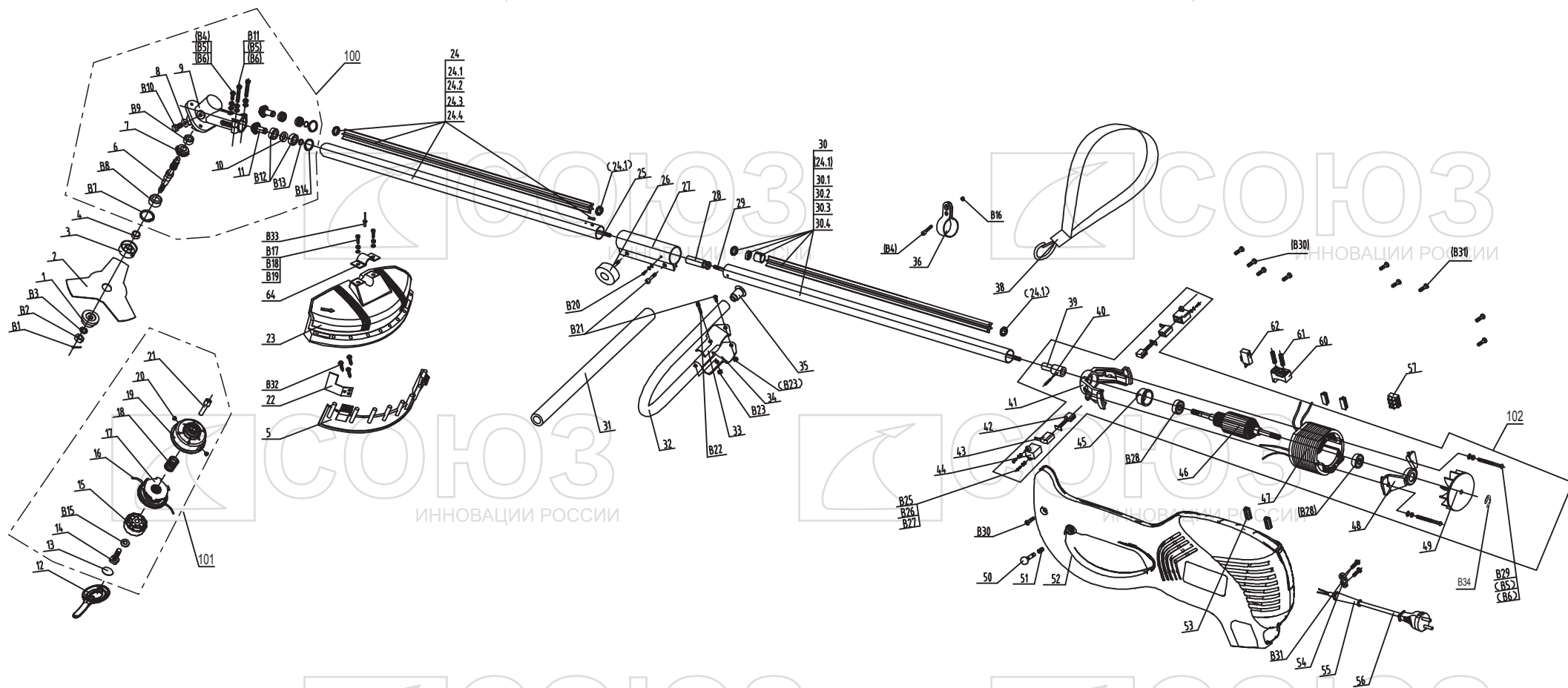

СОЮЗ

ИННОВАЦИИ РОССИИ



СОЮЗ

ИННОВАЦИИ РОССИИ

ГКС-3515

NO.	DESCRIPTION	NO.	DESCRIPTION	NO.	DESCRIPTION
1	DOWN FLANGE	30.2	BUSH	102	MOTOR ASSEMBLY
2	BLADE	30.3	PLASTIC TUBE B	B1	COTTER
3	UPPER FLANGE	30.4	STEEL TUBE B	B2	NUT M10
4	LOCATING BUSH	31	SPONGE TUBE	B3	WASHER 10
5	DOWN GUARD	32	HANDLE	B4	SCREW M5X12
6	SPINDLE	33	HANDLE UPPER CLMAP	B5	SPRING WSHER 5
7	BIG GEAR	34	HANDLE DOWN CLMAP	B6	WASHER 5
8	SEAL RING	35	JAM	B7	CIRCLIP 32
9	GEAR BOX	36	STRAP BASE	B8	BEARING 6201Z
10	WASHER	38	STRAP	B9	BEARING 629Z
11	PINION SHAFT	39	SOFT SHAFT COUPLER	B10	BOLT M8X10
12	PLASTIC SPANNER	40	PIN	B11	SCREW M5X20
13	JAM	41	MOTOR FRONT BRACKET	B12	BEARING 6900Z
14	SQUARE HEAD SCREW	42	CARBON BRUSH	B13	CIRCLIP 10
15	SPOOL COVER	43	COPPER BRUSH HOLDER	B14	CIRCLIP 22
16	NYLON LINE	44	BRUSH HOLDER	B15	WASHER 6
17	BASE OF NYLON LINE	45	BEARING COVER	B16	NUT M5
18	SPRING	46	ROTOR	B17	BOLT M6X20
19	BOX OF NYLON LINE	47	STATOR	B18	SPRING WASHER 6
20	BUSH	48	MOTOR REAR BRACKET	B19	WASHER 6
21	HEXAGONAL SHAFT	49	FAN	B20	SCREW M4X8
22	BLADE	50	ANTI-LOCK LEVEL	B21	SCREW M6X14
23	GUARD	51	SPRING	B22	SCREW M6X32
24	STEEL TUBE ASSEMBLY A	52	HOUSING	B23	NUT M6
24.1	TOOL CIRCLIP	53	RUBBER LINE	B25	SCREW M4X10
24.2	PLASTIC TUBE A	54	CABLE CLAMP	B26	SPRING WASHER 4
24.3	STEEL TUBE A	55	CABLE SLEEVE	B27	WASHER 4
24.4	SHRAPNEL	56	CABLE&PLUG	B28	BEARING 608Z
25	SOFT SHAFT A	57	TERMINAL	B29	SCREW M5X75
26	LOCKING KNOB	60	SWITCH TRIGGER	B30	SCREW ST4.8X12
27	CONNECTION TUBE	61	SPRING	B31	SCREW ST4.2X15
28	SHAFT BUSH	62	SWITCH	B32	SCREW ST4.2X12
29	SOFT SHAFT B	64	GURAD PRESS BOARD	B33	RIVET 4X6
30	STEEL TUBE ASSEMBLY B	100	GEAR BOX ASSEMBLY	B34	CIRCLIP
30.1	TOOL CIRCLIP	101	SPOOL ASSEMBLY		

SO-RU20150331-01